

CO-EX (LABORATORY) TOOLING

**MULTI-FUNCTION STAINLESS STEEL CO-EXTRUDING TOOL
INCLUDES A COMBINATION OF 75 INTERCHANGABLE INSERTS**

EXAMPLES OF PROFILES (CROSS SECTION)

TUBES

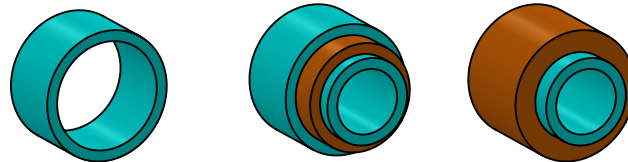

WIRE COATING

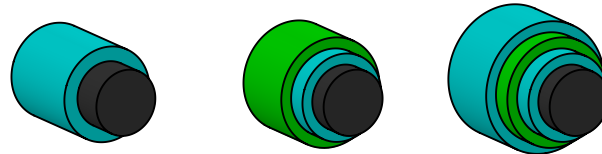

*SOLID CORE
STRANDS / FIBRES*

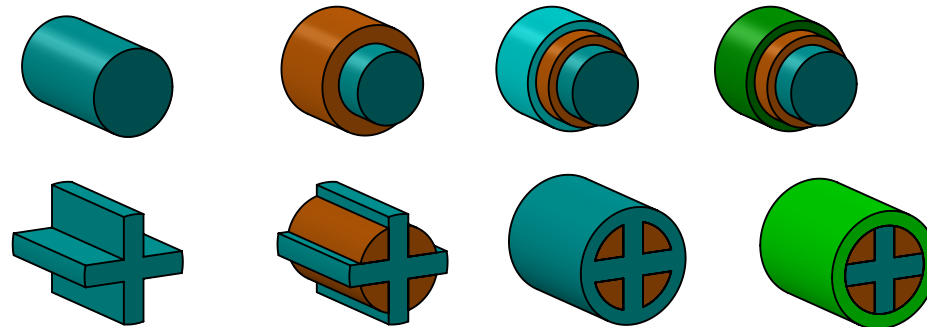

MULTI STRANDS / FIBRES

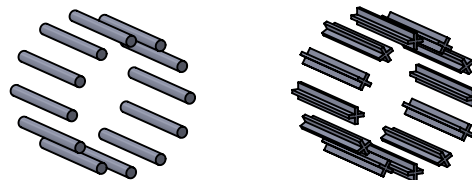

OPTIONAL PROFILES

STRANDS / FIBRES

